



Valleyside

- AT KESWICK -

Legend

- 24 Lot Requires Special Design Consideration
- 40 Suggested House Width (in feet)
- W / PW Walkout/Partial Walkout Lot
- Garage/Driveway Location
- Light Standard
- Fire Hydrant
- Telephone And/Or Video Pedestal
- Transformer/ Switching Cubicle
- Proposed Tree/Shrub Locations (Subject to Change)
- Walking Trails & Paths
- Woodscreen Fence w/Masonry Column
- Woodscreen Fence
- Tubular Steel Fence
- Gate (one per lot)

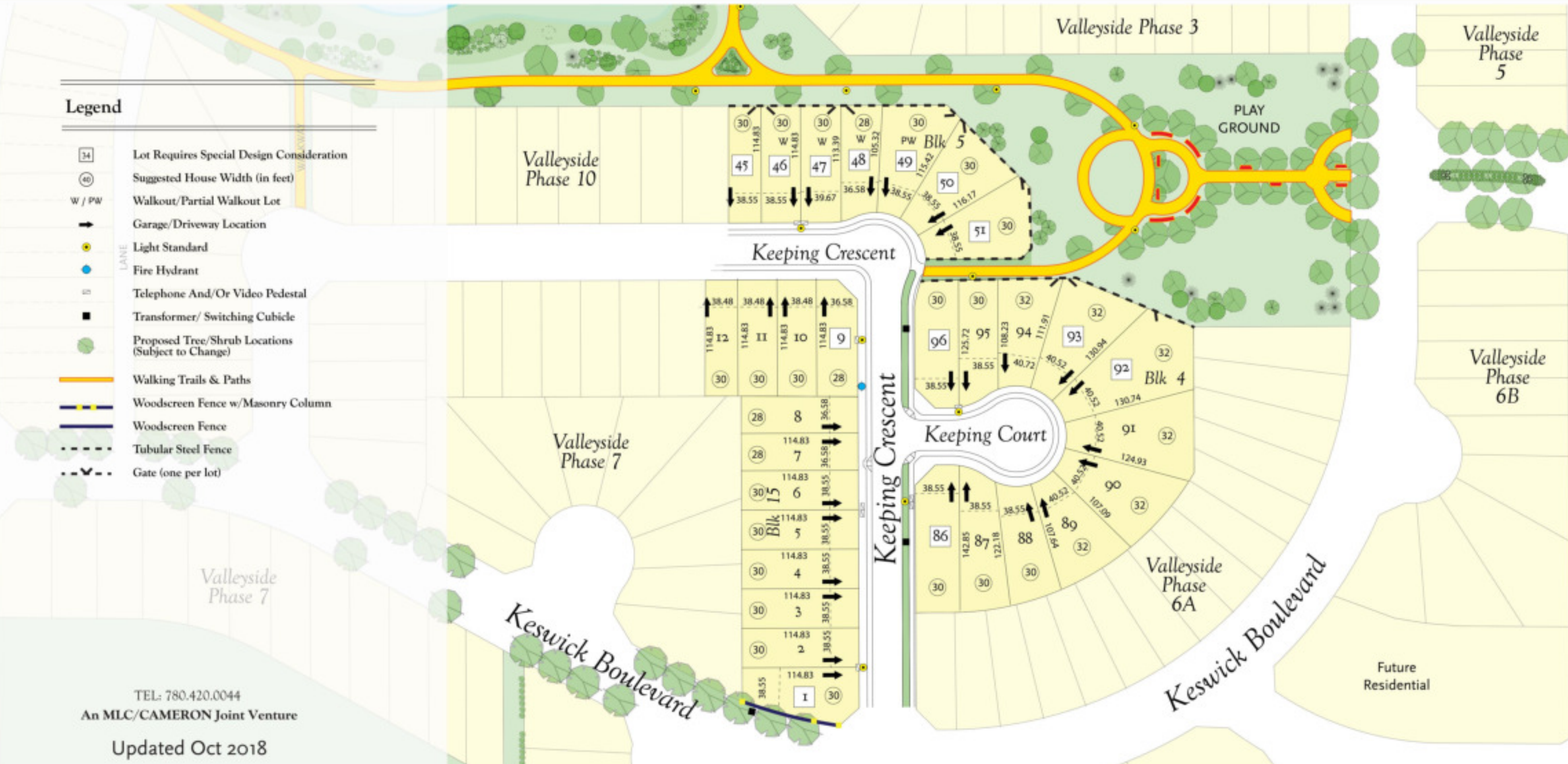

TEL: 780.420.0044
An MLC/CAMERON Joint Venture

Updated Oct 2018

This plan is an information plan only and is subject to change, error and /or omissions. All green spaces, street furniture, and landscaping elements are approximate only and subject to change. Dimension are in feet and decimals. For proposed mailbox locations, please contact Canada Post directly. Contact the City of Edmonton Planning Department for current information. This plan should not be used for design or construction purposes. Keswick Developments accept no responsibility for inappropriate use of this plan.